



Measurement Systems Ltd  
www.measurementsystems.co.uk  
+44 (0) 1635 576800

## Crompton Instruments SC Series Split Core Current Transformers

A range of split core current transformers that offers a cost effective and efficient method by which the current can be measured without the need to break the conductor, thereby reducing installation and commissioning time.

### Specifications

|                       |   |
|-----------------------|---|
| System voltage        | 720V (0.72kV) maximum   |
| Test voltage          | 3kV for 1 minute  |
| System frequency      | 50/60Hz   |
| Insulation class      | E   |
| Overload withstand    | 1.2 times rated current continuously                                    |
| Short circuit thermal | 100 x rated primary for 1 second  |
| Operating temperature | -20 °C to +70 °C  |
| Relative humidity     | 0-90% (non condensing)  |
| Compliant with        | IEC/EN 60044-1, BS7626  |
| Accuracy              | Class 3, 1 & 0.5  |
| Mounting hardware     | Plug-in metal feet for wall or base mounting or moulded busbar mounting |
| Rated dynamic current | = 2.55 x I <sub>ht</sub>  |
| Enclosure             | Flame retardant grade classified UL 94V-O                               |

### Features

- High quality comprehensive measurements
- Available in a wide range of transformer ratings
- Accuracy up to Class 0.5
- Foot or Busbar mounted

### Benefits

- Faster installation
- Cost effective
- Long product life

### Applications

- Switchgear
- Distribution systems
- Generator Sets
- Control panels

# Crompton Instruments SC Series Split Core Current Transformers



**smartprocess**  
control & instrumentation

## Product Codes

|             | Part Number | Ratio   | Burden VA against class index |      |          | Aperture (mm) |
|-------------|-------------|---------|-------------------------------|------|----------|---------------|
|             |             |         | 0.5                           | 1    | 3        |               |
| Case 1      | SC1-100/5A  | 100/5A  | -                             | -    | 1.5      | 20 x 30       |
|             | SC1-150/5A  | 150/5A  | -                             | -    | 2        | 20 x 30       |
|             | SC1-200/5A  | 200/5A  | -                             | 1.5  | 2.5      | 20 x 30       |
|             | SC1-250/5A  | 250/5A  | -                             | 2    | 4        | 20 x 30       |
|             | SC1-300/5A  | 300/5A  | 1.5                           | 4    | 6        | 20 x 30       |
|             | SC1-400/5A  | 400/5A  | 2.5                           | 6    | 10       | 20 x 30       |
| Case 2      | SC2-250/5A  | 250/5A  | 1                             | 2    | 4        | 50 x 80       |
|             | SC2-300/5A  | 300/5A  | 1.5                           | 3    | 6        | 50 x 80       |
|             | SC2-400/5A  | 400/5A  | 1.5                           | 3    | 10       | 50 x 80       |
|             | SC2-500/5A  | 500/5A  | 2.5                           | 5    | 15       | 50 x 80       |
|             | SC2-600/5A  | 600/5A  | 2.5                           | 5    | 15       | 50 x 80       |
|             | SC2-750/5A  | 750/5A  | 3                             | 6    | 20       | 50 x 80       |
|             | SC2-800/5A  | 800/5A  | 3                             | 7.5  | 20       | 50 x 80       |
|             | SC2-1000/5A | 1000/5A | 5                             | 10   | 20       | 50 x 80       |
| Case 3      | SC3-250/5A  | 250/5A  | 1                             | 2    | 4        | 80 x 80       |
|             | SC3-300/5A  | 300/5A  | 1.5                           | 3    | 6        | 80 x 80       |
|             | SC3-400/5A  | 400/5A  | 1.5                           | 3    | 10       | 80 x 80       |
|             | SC3-500/5A  | 500/5A  | 2.5                           | 5    | 15       | 80 x 80       |
|             | SC3-600/5A  | 600/5A  | 2.5                           | 5    | 15       | 80 x 80       |
|             | SC3-750/5A  | 750/5A  | 3                             | 6    | 20       | 80 x 80       |
|             | SC3-800/5A  | 800/5A  | 3                             | 7.5  | 20       | 80 x 80       |
|             | SC3-1000/5A | 1000/5A | 5                             | 10   | 20       | 80 x 80       |
| Case 4      | SC4-500/5A  | 500/5A  | -                             | 4    | 12.5     | 80 x 120      |
|             | SC4-600/5A  | 600/5A  | -                             | 5    | 15       | 80 x 120      |
|             | SC4-750/5A  | 750/5A  | 2.5                           | 6    | 17.5     | 80 x 120      |
|             | SC4-800/5A  | 800/5A  | 3                             | 7.5  | 20       | 80 x 120      |
|             | SC4-1000/5A | 1000/5A | 5                             | 10   | 20       | 80 x 120      |
|             | SC4-1200/5A | 1200/5A | 6                             | 12.5 | 25       | 80 x 120      |
|             | SC4-1250/5A | 1250/5A | 7.5                           | 15   | 30       | 80 x 120      |
|             | SC4-1500/5A | 1500/5A | 8                             | 17   | 30       | 80 x 120      |
| Case 5      | SC5-1600/5A | 1600/5A | 8                             | 17   | 30       | 80 x 120      |
|             | SC5-1000/5A | 1000/5A | 10                            | 15   | 20       | 80 x 160      |
|             | SC5-1250/5A | 1250/5A | 10                            | 15   | 20       | 80 x 160      |
|             | SC5-1500/5A | 1500/5A | 15                            | 20   | 25       | 80 x 160      |
|             | SC5-2000/5A | 2000/5A | 15                            | 20   | 25       | 80 x 160      |
|             | SC5-2500/5A | 2500/5A | 15                            | 20   | 25       | 80 x 160      |
|             | SC5-3000/5A | 3000/5A | 20                            | 25   | 30       | 80 x 160      |
|             | SC5-4000/5A | 4000/5A | 20                            | 25   | 30       | 80 x 160      |
| SC5-5000/5A | 5000/5A     | 20      | 25                            | 30   | 80 x 160 |               |
| SC5-6000/5A | 6000/5A     | 20      | 25                            | 30   | 80 x 160 |               |

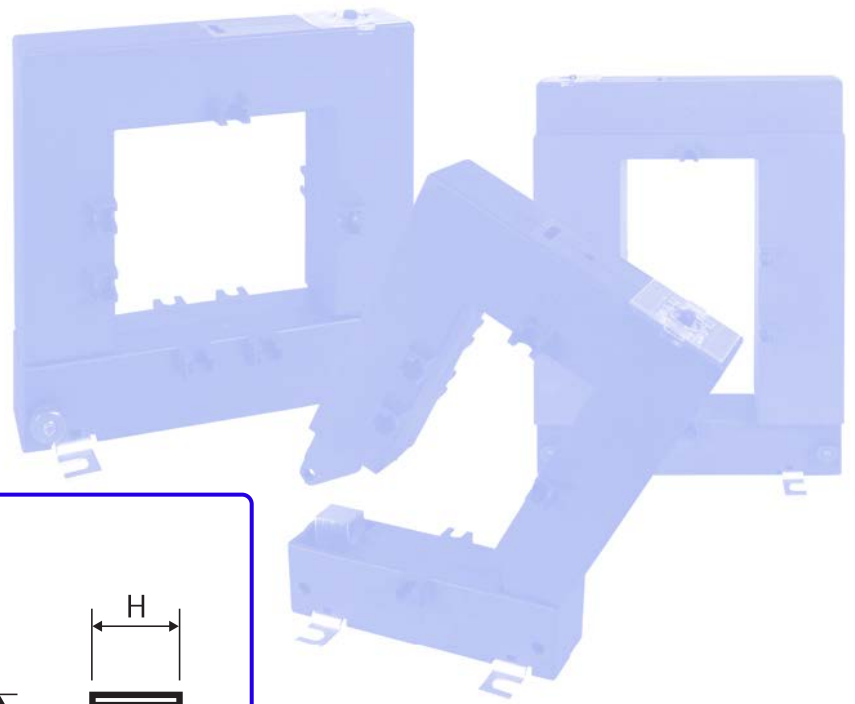

**Dimensions (mm)**

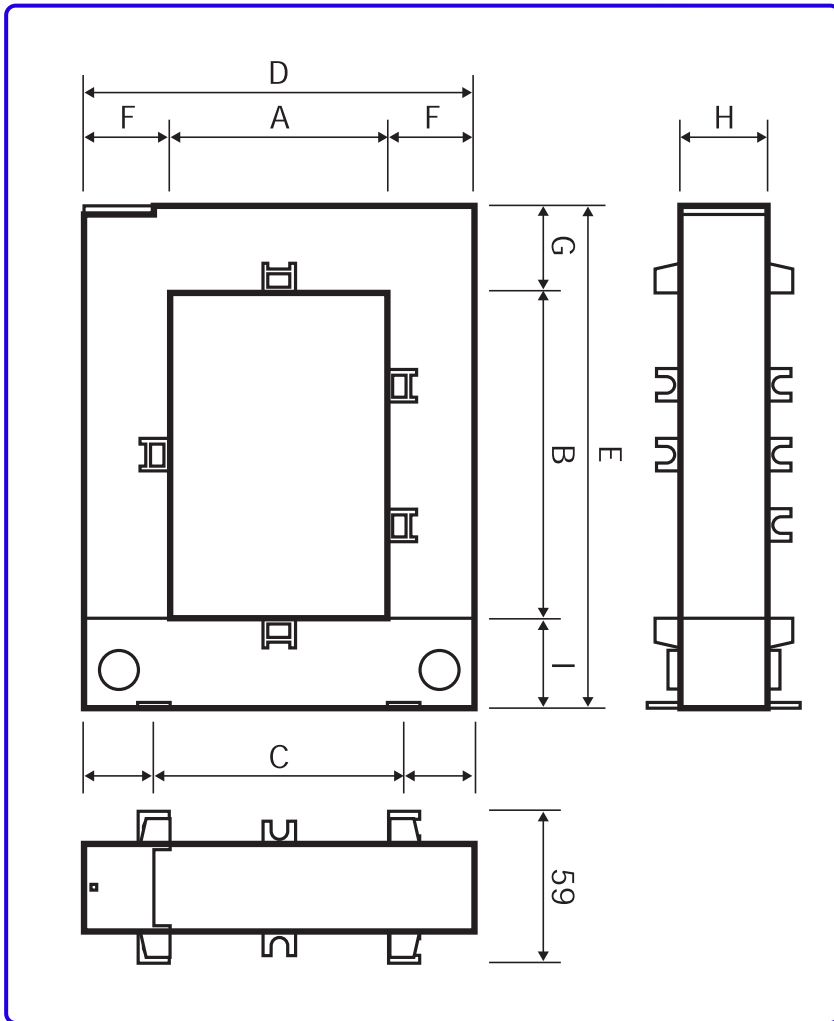

| Model              | Case 1 | Case 2 | Case 3 | Case 4 | Case 5 |
|--------------------|--------|--------|--------|--------|--------|
| <b>A</b>           | 20     | 50     | 80     | 80     | 80     |
| <b>B</b>           | 30     | 80     | 80     | 120    | 160    |
| <b>C</b>           | 51     | 78     | 108    | 108    | 120    |
| <b>D</b>           | 89     | 114    | 144    | 144    | 184    |
| <b>E</b>           | 111    | 145    | 145    | 185    | 245    |
| <b>F</b>           | 34     | 32     | 32     | 32     | 52     |
| <b>G</b>           | 47     | 32     | 32     | 32     | 52     |
| <b>H</b>           | 40     | 32     | 32     | 32     | 52     |
| <b>I</b>           | 32     | 33     | 33     | 33     | 38     |
| <b>Weight (kg)</b> | 0.75   | 0.90   | 1.05   | 1.25   | 4.30   |